



Dear Parents and Caregivers

Dates for Your Diary

February

- 20 Meet the Teacher Evening-tonight
27 Working Bee morning with Costa

March

- 6 District Swimming Carnival
12 P&C Meeting
13 Show "Bully No More"
14 Picnic Under the Stars
18 School Photos
21 Grandparents Morning Tea (Kindergarten only)
22 Last day of PSSA Sport

April

- 12 Last Day of Term 1

MEET THE TEACHER EVENING- TONIGHT

WHEN: Wednesday, 20th February 2013

WHERE: Your Child's Classroom

TIME: Kindergarten –Year 2

5.00pm – 5.45pm

YEAR 3 – YEAR 6.

5.45pm – 6.30pm

Supervision

A reminder that supervision for students commences at 8.50am in the mornings. Teachers are not on duty before this time and children's safety cannot be assured. Students who arrive before 8:50am must be seated on the silver seats. Similarly students need to be collected by 3.20 pm unless attending after school lessons.

Online Payments Now Available!

It is now possible to make online payments to the school via a secure payment page hosted by Westpac. Payments can be made using either a Visa or MasterCard credit or debit cards.

Details of the payments are passed daily to the school where they will be receipted against your child's account.

Here's how to do it...

1. Go <http://www.rosebay-p.schools.nsw.edu.au/>
2. Select **\$ Make a payment**
3. Enter the students name & class & date of birth
4. Make a Payment
5. Save, Print or email your receipt

School fees are out this week so it is a great opportunity to give the online payment system a try. Many parents have already taken advantage of this convenient service.

This is a secure payment system hosted by Westpac to ensure that your credit/debit card details are captured in a secure manner, these details are not passed back to the school. Credit Card details need to be entered each time you make a payment.

School Council

If you would like to nominate yourself as a parent representative on the School Council please see the office staff for nomination forms. Nominations close at 3.20pm Friday 22 February. If there are more than three parents who nominate an election will be announced. I urge parents to consider taking a position on the Council.

SEVERE FOOD ALLERGIES

We have several student at Rose BayPublic School who have severe allergic reactions to certain foods which can cause anaphylaxis shock which is potentially life threatening.

Peanut and tree nuts, egg and fish are amongst the triggers for these students. The parents and teachers of these students have implemented strategies to monitor the students diets and exposure to these products .

However, we ask that parents and carers refrain from sending to school any nut-based foods and reinforce with their children that they must not share food with other students. Should you wish to celebrate your child's birthday with their classmates, please check with your child's teacher first before sending in any cakes or other treats. It is also appreciated that if you do send in cakes that cup cakes, enough for one per child, be sent rather than a whole cake.

Teachers have been updated with the current anaphylaxis procedures and will undergo more training during the year.

We appreciate your cooperation in these matters.

Sign in at the Office.

The school security gates will be locked during the day from 9.45am until 2.30p.m with the exception of the main Albermarle street gate which will remain unlocked. Outside of pick up or drop off times, all visitors to the school including parents and carers must report to the school office on arrival, sign in and wear a visitors badge. Exceptions are made for special events such as assemblies or whole school performances, open days etc.



First P&C Meeting

The first meeting of the P&C for the year was held on **Tuesday evening**. The P&C does valuable work in supporting the school and raising much needed funds to supplement the school budget to provide quality resources for our students. It is an opportunity for parents and carers to become involved and assist the school in providing your children with the best education possible. I would like to thank the P&C for the donation of \$50 000 which will enable us to proceed with ordering two mobile wireless computer labs. These will be for our senior classrooms.

The school appreciates the efforts of the P&C and the various committees that support the school and I encourage all families to consider becoming involved.

Become an Ethics Teacher at Rose Bay Public School

Primary Ethics provides the opportunity for NSW public primary school students who don't attend scripture classes (SRE) to participate in philosophical ethics classes. We need a new volunteer to teach Years 3&4 ethics classes & classes later in the year for Years 1&2. The classes teach children how to approach ethical issues and develop their capacity for considered moral judgment, which will enable them to respond more thoughtfully to many of the problems and issues they will face in their lives.

Volunteer Ethics Teachers are trained to deliver our age- appropriate curriculum every week and to use the accompanying learning and teaching materials. For more information about the role and to volunteer, please go to

<http://www.primaryethics.com.au>

Di Adams (Ethics Coordinator)0407 365 745

Medical Action Plans

Thank you to all the parents and carers who have provided the school office with their child's medical action plan. If your child suffers from any health issues such as Anaphylaxis, asthma,diabetes, epilepsy etc, the school needs to be given a medical action plan which you can get from your doctor. The school keeps this information in central locations (staff room, office, casual folders, classrooms, canteen etc.) so that all staff members are aware of these medical conditions.

Your Voice in Our School

Rose Bay P&C highlights

Tuesday 12 February Meeting highlights: We had a fantastic first P&C for the year focused on planning for 2013. The minutes of the meeting and the plans we generated will be available for general distribution soon.

We also voted to support the school's request to fund one mobile computer lab (with 30 laptops)!! This computer lab will be located in the senior classes and will have the additional benefit of freeing up the library based PC computer lab for the junior years. The P&C is proud to be able to support our children's education.

For your diaries: Thursday 14th March 5.30pm- 8.00pm

We would like to invite all Rose Bay Public School families to a Picnic Under the Stars on the school grounds. We will advertise more about this fun school event in the coming weeks.

Traffic Committee Call for Volunteers: If you are able to volunteer 20 minutes of your time (just one afternoon a week or fortnight) to help supervise the Wilberforce Ave pick up zone please send an email to the Traffic Committee: mimi@nixon.com.au

Environment Committee Working Bees: The focus for the first two terms of the year will be the kindergarten garden area and kindergarten entrance area from the gate to the hallway ramp. The recent working bees saw clearing and beginning of mulch along Albermarle Lane pathway and garden – thanks to all those families that supported this activity. The next dates for working bees will be:

- Wednesday 27th February 9.30am-10.30am
- Wednesday 27th March 9.30am -10.30am



Come and join in the fun!!

CALLING ON ALL PARENTS.

We once again have the opportunity to help clean up Australia

(and those cluttered drawers in your home)

We are asking all parents who have old mobile phones, which you have been meaning to throw out, when you got the chance to send them in to the school and leave them in the box provided opposite the Library stairway and under the rainbow artwork.

A Melbourne company recycles these phones for poorer nations who can't afford, but need phones, and they send money for the school's fundraising efforts.



Just a reminder to all school families, dogs are not allowed on the school premises at any time. This includes tying them to the school fence, inside or outside the school gates. Thank you for your assistance in ensuring the safety of our children.



Healthy Kids Association is a not for profit organisation with a mission to promote and influence healthy food choices for school aged children. Healthy Kids is the primary source of advice to 3000 schools in NSW on school canteens. We are a member organisation and supported by the NSW government. For more information – www.healthy-kids.com.au

Canteen News

There are some small changes in the way the canteen operates. The canteen is no longer open before school. As well as helping us keep costs down, this time is used to cook and prepare fresh foods for the children, do the ordering and restocking. Thankyou for your understanding.

Join the 192 Families who have Got Online -WOW

Big thank you to the **192 school families** who have signed up and are using FlexiSchools. It does help us with our operations in the canteen.

Please join with them and order your child's lunch on line. This system allows you to place orders from home, work or school at any time typically up until 9:30am for that day's service. The payment is also done online, so **you no longer need to send cash or a paper order to school.**

Getting online **is easy and only takes a second to register.** Simply go to www.flexischools.com.au and click "**Register Now**". You will be sent an email with further instructions on how to complete the registration. Once registered, you can start placing orders immediately. If you have any questions, FlexiSchools provide a great help desk on 1300 361 769, or you can contact them via their website.

Avoid merchant fees - do a bank transfer. The system operates via a pre-paid account, so you don't need to scrounge for coins in the morning and can easily budget for your canteen spending throughout the term.

Ideas and Suggestion

Please don't hesitate to provide ideas and suggestions about your canteen service. Shortly we will look to develop the winter menu. You can either drop a note in the box at the canteen, have a discussion with Cathy, your canteen manager, or email: info@healthy-kids.com.au

Placing Lunch Orders at the Canteen

Parents and children can drop their lunch orders in the box outside the canteen. We do provide paper bags should you need to complete the order at school. Paper bags are 10 cents each.

Mondays in the Canteen

Healthy Kids Association is working hard to keep the price of menu items down and to continue to provide freshly cooked and prepared food items – we can only do this if we are covering our costs.

Every Monday there is fresh bread, wraps and healthy fruit muffins – So why not consider ordering your child's lunch on Mondays. It's a great start to the week.

RBPS 2013 Swimming Carnival

On Wednesday 6th February 2013 our Swimming Carnival was held at Waverley College Pool. All students had the opportunity to participate in a variety of swimming races or a kickboard race throughout the day. The carnival was a fabulous day for everyone involved including children, staff and the many parents who gave up their time to come and support!!

The day was a success due to the efforts of both our exceptional teachers who worked so hard during the day to ensure everything ran to plan and a number of parents who stood all day timing or providing the teachers with much needed coffee – a very big thank you to all of you. Another thank you must go to our Sports Captains for their leadership during the day.

Well done to EVERY student who got in the pool for one or many events on the day – every time you got in the pool you received a point for your house colour team!! Congratulations to the swimmers listed below who excelled on the day!! The overall places are worked out by the fastest times from all heats combined. Well done to Wentworth House for having the highest overall score on the day.

EVENT	1st Place	2nd Place	3rd Place
Girls Open 100m Freestyle	Jordan Rountree	Isabella Cavallaro	Sophia Mackinnon
Boys Open 100m Freestyle	Brock Lopes	Jesse Caminer	Jackson Fredericks
Girls 8 yrs 50m Freestyle	Lily McCowan	Sophia Clyne	Bo McDonald
Boys 8 yrs 50m Freestyle	Jack Simon	Matija Beric	Mackenzie Charles
Girls 9 yrs 50m Freestyle	Gabrielle Gencher	Jessie Styles	Claudia Foxman
Boys 9 yrs 50m Freestyle	Charlie Michell	Charlie Germane	Luka Gillibrand
Girls 10 yrs 50m Freestyle	Lara Freund	Tara Linker	Abby Perkins
Boys 10 yrs 50m Freestyle	Harrison Charles	Jordan Chapman Race	Alex O'Neill
Girls 11 yrs 50m Freestyle	Olivia Stanton-King	Thea Phillips	Tawny Myers
Boys 11 yrs 50m Freestyle	Brock Lopes	Dylan Christie	Tommy Bailey
Girls 12 yrs 50m Freestyle	Jordan Rountree	Isabel Coates	Isabella Cavallaro
Boys 12 yrs 50m Freestyle	Jesse Caminer	Jackson Fredericks	Jake Edelman
Girls Junior Breaststroke 50m	Lily McCowan	Abby Perkins	Gracie Hyde
Boys Junior Breaststroke 50m	Ryan von der Heyden	Jonah Trope	Declan Sullivan
Girls 11 yrs Breaststroke 50m	Thea Phillips	Olivia Stanton-King	Lauren Cronin
Boys 11yrs Breaststroke 50m	Brock Lopes	Kfir Ross	Nathan Peisah
Girls 12 yrs Breaststroke 50m	Joran Rountree	Jackie Small	Tilda Njoo
Boys 12 yrs Breaststroke 50m	Jesse Caminer	Jackson Fredericks	Yonatan Freund
Girls Junior Backstroke 50m	Lily McCowan	Tara Linker	April Lewis
Boys Junior Backstroke 50m	Charlie Michell	Ryan von der Heyden	Kian Uchitel
Girls 11yrs Backstroke 50m	Olivia Stanton-King	Thea Phillips	Lara Feller
Boys 11yrs Backstroke 50m	Brock Lopes	Matthew Cussen	Roman Baranov
Girls 12 yrs Backstroke 50m	Jordan Rountree	Eden Filler	Isabella Cavallaro
Boys 12 yrs Backstroke 50m	Jesse Caminer	Jake Edelman	Jackson Fredericks
Girls Junior Butterfly 50m	Lily McCowan	Olivia Clyne	Tali Loupo
Boys Junior Butterfly 50m	Charlie Michell	Finnegan Callanan	Jonah Trope
Girls 11 yrs Butterfly 50m	Luisa Coffey	N/A	N/A
Boys 11 yrs Butterfly 50m	Brock Lopes	Matthew Cussen	Tommy Bailey
Girls 12 yrs Butterfly 50m	Jordan Rountree	Sophia Mackinnon	Isabella Cavallaro
Boys 12 yrs Butterfly 50m	Jesse Caminer	Jackson Fredericks	Alexander Kapos

Samantha Mills (PE Teacher)

A note from the RBPS Parent Traffic Committee



Drop off and pick up zone - Wilberforce Ave

The entire school frontage on Wilberforce Ave is a "No Parking" zone during peak times and is now officially a Pick-up / Drop off area. If you are dropping off or picking up your child here please adhere to the following:

Do:

- Wait in your car at all times.
- Move your car all the way to the front end of the two minute zone to allow other cars to move in behind you. Keep moving forward as spots open up in front of you.
- Explain the pick-up procedure to your children so they understand they may need to wait for you along the wall for a few minutes in the afternoons.
- Be patient. It may take a little longer to pick up your children (particularly in wet weather) but for safety reasons it is extremely important that everyone follows these procedures.
- Be swift when picking up your child.

Don't:

- Stop in the first spot you see. Please go all the way to the front of the two minute zone to allow other cars to move in behind you.
- Leave your car, even for a minute or two. A staff member or parent volunteer will assist your child to the car. If you need to go into school, please park elsewhere legally.
- Use this time to catch up with other parents for a chat - this holds up others waiting to join the car line.

Parking - please see parking plan on next page

- It is not only illegal but also dangerous to **double park** or park in a **no stopping zone**. Please do not **park across driveways**. It is illegal and also inconsiderate to the school's neighbours.
- If you wish to come into the school you are encouraged to **walk, cycle or scooter** if possible.
- If driving is necessary, please **park in an adjoining street** and enjoy the short walk to school. Perhaps you could arrange to **car pool** with your neighbours?
- *Woollahra Council has indicated it will be sending additional rangers to the school to monitor compliance.*

School bus

- Did you know the school has its own **dedicated afternoon bus**? Bus 606 stops directly outside the school on Albemarle Ave every afternoon. A teacher supervises the children as they wait for and board the bus. The bus travels to Bondi Junction via Bondi Beach. See <http://www.sydneybuses.info/schools>
- Children who live more than 1.6km from the school (radial distance) and all children in K-2 are entitled to a free school bus pass. Application forms are at the office. Children not eligible for free travel may use the bus as fare payers. Term bus passes are available from State Transit.
- We have applied to Sydney Buses for an extra service to cover the Rose Bay North/Vaucluse/Dover Heights areas. We will keep you posted of progress on this.

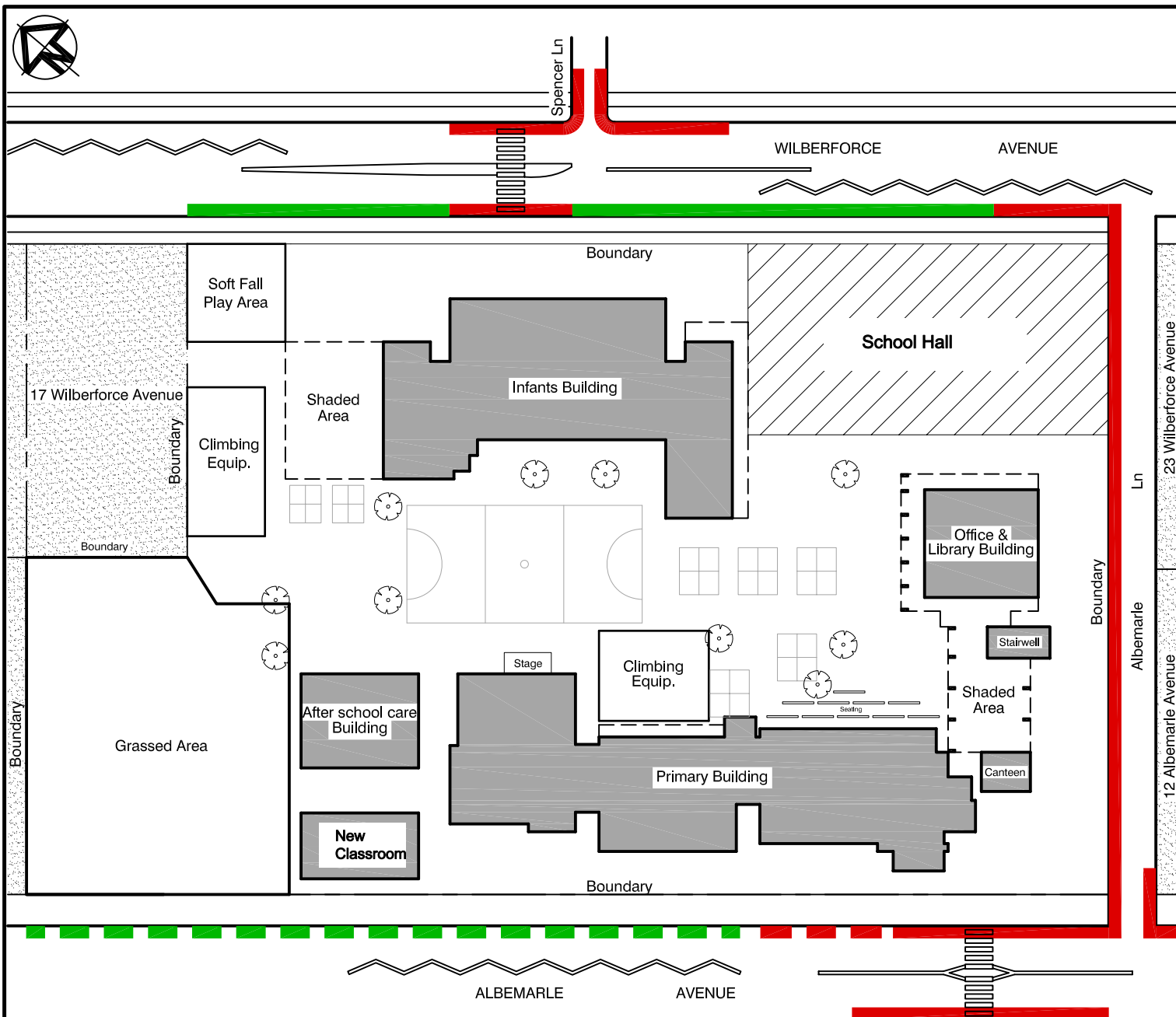

If you are able to volunteer 20 minutes of your time (just one afternoon a week or fortnight) to help supervise the Wilberforce Ave pick up zone please send an email to the Traffic Committee: mimi@nexon.com.au

Thank you for helping keep our kids safe.





ROSE BAY PUBLIC SCHOOL PARKING PLAN

DRAWING LEGEND:

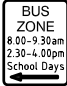
 **NO STOPPING**
 **NO STOPPING**
 You **MUST NOT STOP** in this zone. Stopping in a no stopping zone, even for a short time is illegal. The fine for stopping in a NO STOPPING zone is:
\$298 + 2 points

 **BUS ZONE**
 **BUS ZONE**
 8.00 - 9.30am
 2.30 - 4.00pm
 School Days
 You **MUST NOT STOP** in this zone. Stopping in a bus zone even for a short period is illegal. The fine for stopping even quickly to unload is:
\$298 + 2 points

 **NO PARKING**
 **NO PARKING**
 8.00 - 9.30am
 2.30 - 4.00pm
 School Days
 This means that drivers are not allowed to stop their vehicles, except for when they are picking up or setting down goods or passengers. The driver of the vehicle may only stop for a maximum of 2 minutes and the driver cannot move more than 3 meters away from the vehicle. This is the equivalent of a kiss and drop. Stop, unload the bags and children, hug/kiss and drive away. Disobey this sign:
\$165 + 2 points

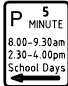
 **P5 MINUTE**
 **P5 MINUTE**
 8.00 - 9.30am
 2.30 - 4.00pm
 School Days
 Allows driver to park the car and escort the children into the playground. Driver must return to vehicle and drive away within 5 minutes. This requires strict co-operation so that other parents of young children (kinder/infants) may also do the same. Disobey sign:
\$165 + 2 points

DOUBLE PARKING
 Even for a short time, is illegal

\$298 + 2 points

A cinquain - which, by the way, is pronounced "sin-cane," not "sin-kwane" - is a form of poetry that is very popular because of its simplicity.

5/6M have written some great cinquains about themselves:

LILLA
Sporty, Artistic
Baking, Painting, Running
Extraordinary at almost
everything
Awesome

JAYDEN
SPORTY, FUNNY
RUNS, BOWLS, BAT'S
GOOD AT PLAYING CRICKET
HUMOROUS

JADE
FLEXIBLE, MUSICAL
DANCING, SINGING, SURFING
A KIND, SOCIAL PERSON
GEMSTONE

DANIEL
NICE, HELPFUL
RUNNING, TRIPPING, SINGING
WANT TO BE MYSELF
UNIQUE

JORDAN
ATHLETIC, COURAGEOUS
RUNNING, GOALKEEPING,
DRAWING
LOVES TO PLAY SOCCER

JENNIFER
DILIGENT, ORGANISED
STUDYING, DANCING, READING
VALUES KNOWLEDGE AND LITERATURE
PUPIL

NATHAN
HUMOROUS, INTERESTING
SLEEPY, SPORTY, CYCLING
SOMEONE THAT LOVES ANIMALS
CRAZY

**PARKS
CLINIC**

established 1990

12 Junction Street Woollahra
phone 9389 4512
email info@parksclinic.com
www.parksclinic.com

Dr Frances Gibson

developmental psychologists assess kids'
academic strengths and weaknesses

**PARKS
CLINIC**

established 1990

12 Junction Street Woollahra
phone 9389 4512
email info@parksclinic.com
www.parksclinic.com

Dr Ann Rémond

speech & language pathologists help kids
communicate better

**PARKS
CLINIC**

established 1990

12 Junction Street Woollahra
phone 9389 4512
email info@parksclinic.com
www.parksclinic.com

Dr Henry Luiker
Marije Vrieze
Nicola Macdonald

psychologists help kids* with sad, angry,
worried or confused feelings
(*and their families)

**PARKS
CLINIC**

established 1990

12 Junction Street Woollahra
phone 9389 4512
email info@parksclinic.com
www.parksclinic.com

Mari Carmen Escribano
Kelly Avis
Nikki Simler

occupational therapists help kids with writing,
coordination, sequencing & organisation

To advertise in the Rose Bay Public School
newsletter please ring the office on (02) 9371 4884